

**A.ZEUS**

お客様の笑顔を糧に…。



# LED HIGHBAY LIGHT

## HBL-02-G7

60W / 80W / 100W / 120W

180lm/W



**Cold Forging Technology , AL1070 Pure Aluminum.**

**Application :** Workshops & Sport Facilities, Storage Facilities & Warehouses,  
Supermarkets & Department Stores, Showrooms, Design Centers & Galleries,  
Shopping Center, Airport Center.



**A.ZEUS**

お客様の笑顔を糧に...

# LED HIGHBAY LIGHT

## HBL-02-G7

60W/80W/100W/120W

## Photometry

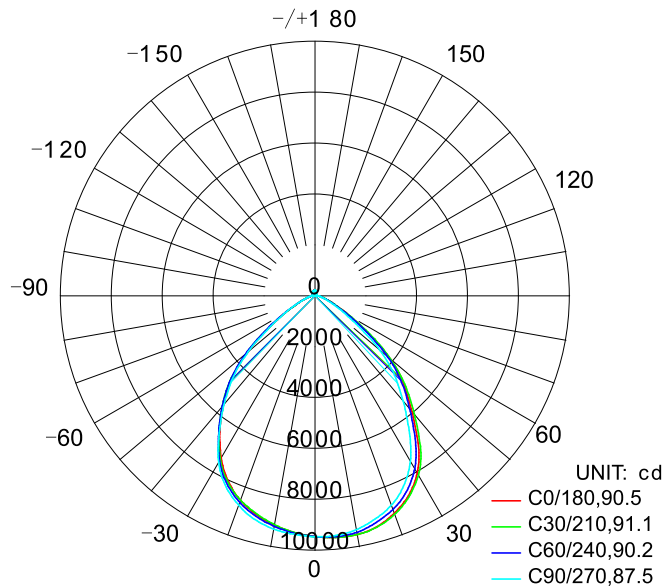

170lm/W



AC100-277V 50/60Hz



Easy Installation



Waterproof



Life Span:  
>50,000 Hours

**A.ZEUS**

お客様の笑顔を糧に...

# LED HIGHBAY LIGHT

## HBL-02-G7(B)

60W/80W/100W/120W

## Photometry

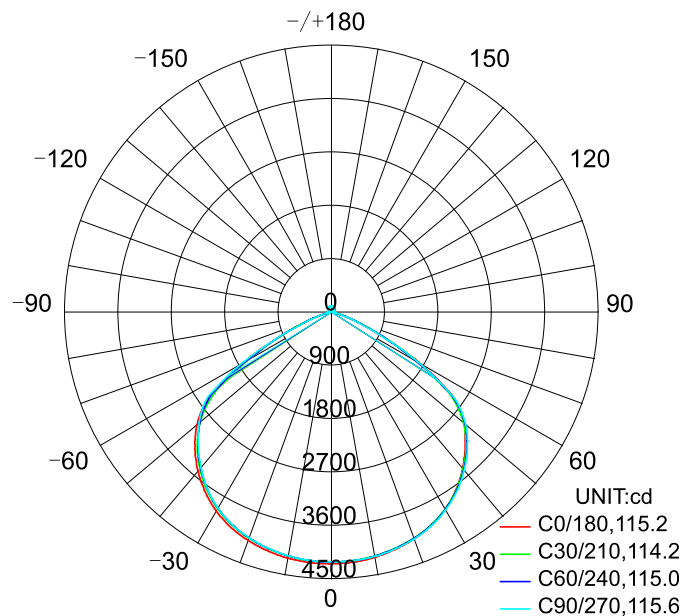

AVERAGE BEAM ANGLE(50%):115.0 DEG

120°



160lm/W



AC100-277V 50/60Hz



Easy Installation



Waterproof



50,000h

Life Span:  
>50,000 Hours

## Our highbay light

## Highbay from other company

### 1.Appearance

- The appearance adopts cold forging integrated molding process, which makes the product more interesting, aesthetic and full of highlights and industrial sense.



- The appearance is stiff which lack of beauty.

### 2.Heatsink

- Heatsink adopts pure aluminum -cold forging technology, which has strong thermal conductivity, large heatsink area, good heat dissipation performance and especially weight is lighter.



- Heatsink use fin-shape aluminum, which can not fit with PCB completely, that lead to a bad thermal conductivity and will have a risk of losing as time pass by.

## Our highbay light

## Highbay from other company

### 3. Power supply

- Independent modular design for power supply, including SPD 2KV. Built-in thermal paste to ensure a better heat dissipation and waterproof. Besides, the PC driver cover can anti-high temperature, anti-deformation, and does not change color for a long time, easy cleaning.

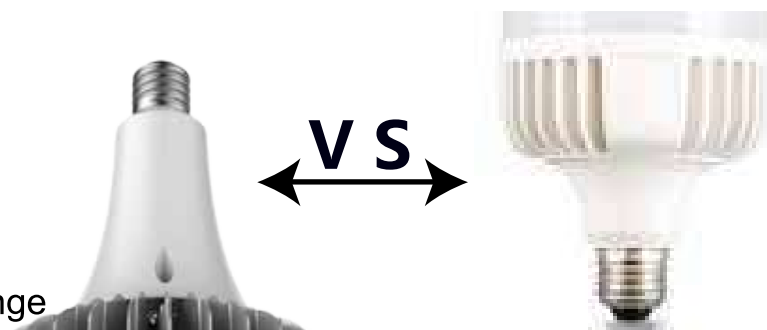

- Internal driver without thermal paste inside the driver box, which lead to a bad heat dissipation and waterproof.

### 4. PC LENS

- Use Optical PC lens, low temperature, light transmittance up to 95%.
- HBL-02-G7-There is a hole in the middle of lens, which increased air convection and has a better heat dissipation to maintain a low temp on chip and driver .
- HBL-02-G7(B)-Unique optical design, High uniform light distribution, No frequency, Anti-glare.



- No optical design, high UGR value, Glare for output light.
- The lens cannot help to heat dissipation.

## Our highbay light

## Highbay from other company

### 5. Waterproof

- Adopts silicon rubber ring on lens, perfect IP65 waterproof.



- No rubber ring, only IP40 waterproof.

### 6. LED

- High brightness SMD 5050 chip, 180lm/W, 50000hrs lifespan.



- SMD 5730、2835、3030, Only 90-110lm/W.

### 7. Installation

- Use international standard E39/E40 base, wide application, durable, which can be ceiling/hanging installation.



- Use hoisting ring, E39/E40 base can not be compatible.

**A.ZEUS**

お客様の笑顔を糧に...

# LED HIGHBAY LIGHT

## HBL-02-G7

**170**  
lm/W

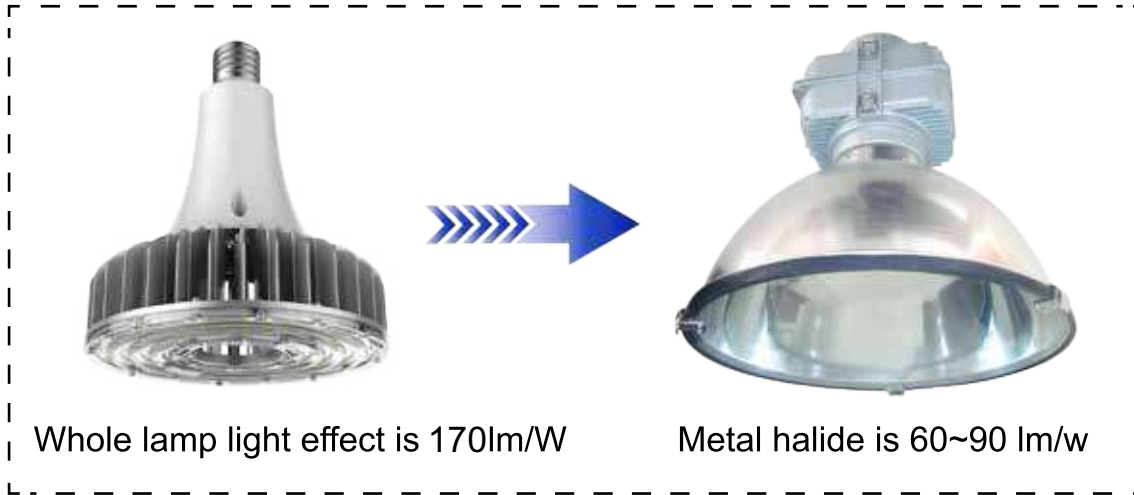

Whole lamp light effect is 170lm/W

Metal halide is 60~90 lm/w

60W replace 180W metal halide  
80W replace 250W metal halide

100W replace 300W metal halide  
120W replace 350W metal halide

### Thermal conductivity comparison chart

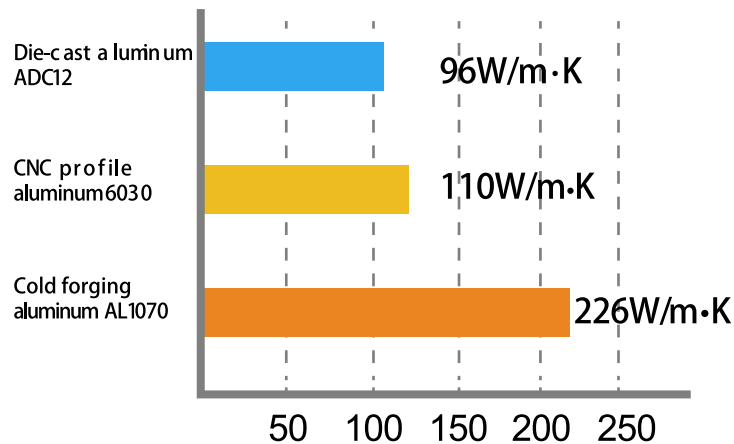

Flux out: 12965 lm

Height	Eavg, Emax	Diameter
2m	1106, 2393lx	379.79cm
4m	276.6, 598.2lx	759.59cm
6m	122.9, 265.9lx	1139.38cm
8m	69.15, 149.5lx	1519.18cm
10m	44.25, 95.7lx	1898.97cm
15m	19.67, 42.5lx	2848.46cm
20m	11.06, 23.9lx	3797.95cm
25m	7.081, 15.3lx	4747.43cm
30m	4.917, 10.6lx	5696.92cm
35m	3.613, 7.8lx	6646.41cm

Height Eavg, Emax Angle: 87.03deg Diameter

Note: The Curves indicate the illuminated area and the average illumination when the luminaire is at different distance.

**A.ZEUS**

お客様の笑顔を糧に…。

# LED HIGHBAY LIGHT



60W, 80W, 100W, 120W

Beam Angle: 90°/120°

Led Brand: SMD 5050

Weight: 1.64kg

170  
lm/W



HBL-02-G7



HBL-02-G7(B)



# LED HIGHBAY LIGHT HBL-02-G7

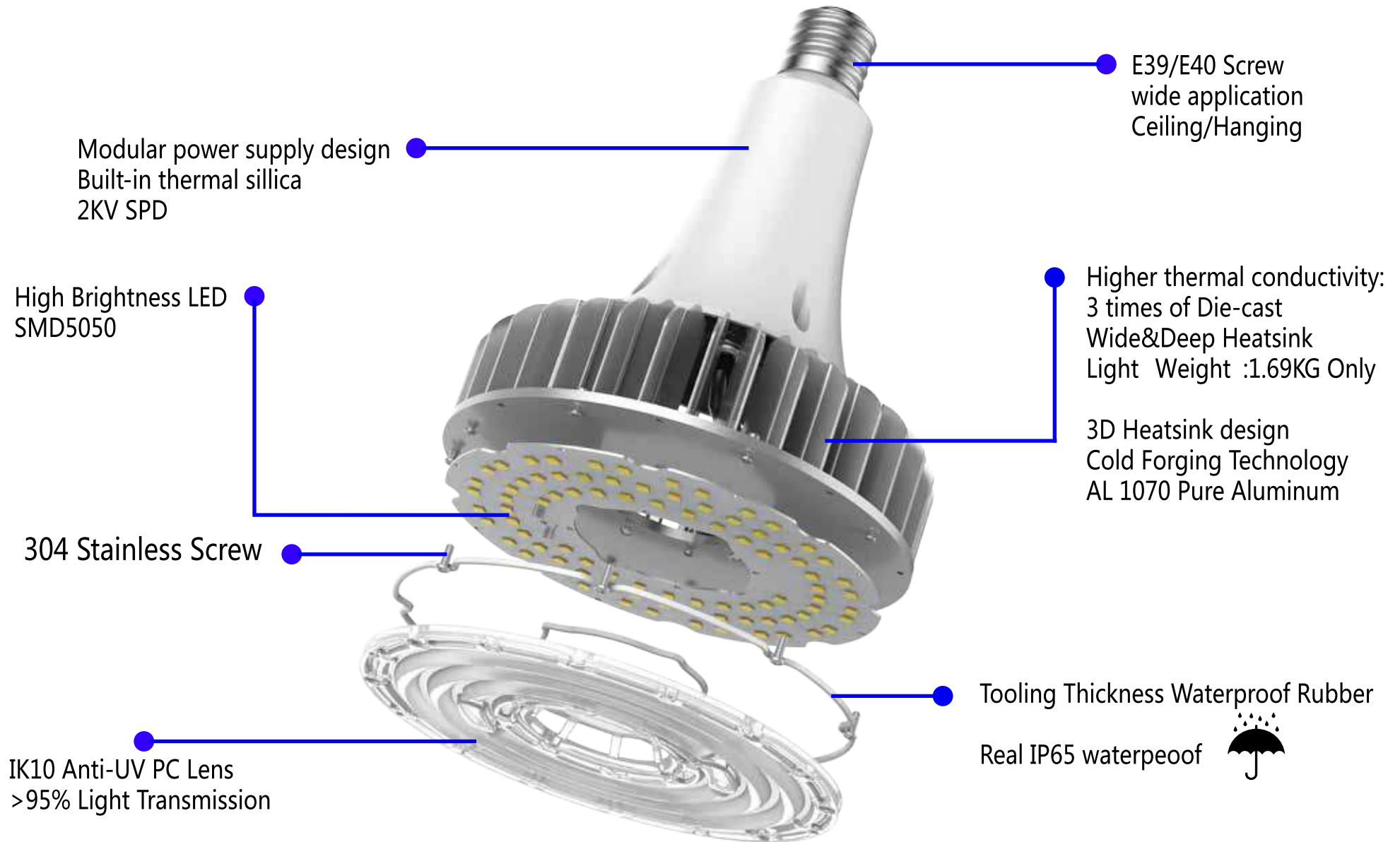

E39/E40 Screw  
wide application  
Ceiling/Hanging

Modular power supply design  
Built-in thermal silica  
2KV SPD

Higher thermal conductivity:  
3 times of Die-cast  
Wide&Deep Heatsink  
Light Weight :1.69KG Only

3D Heatsink design  
Cold Forging Technology  
AL 1070 Pure Aluminum

High Brightness LED  
SMD5050

304 Stainless Screw

Tooling Thickness Waterproof Rubber  
Real IP65 waterpeoof 

IK10 Anti-UV PC Lens  
>95% Light Transmission

# A.ZEUS

お客様の笑顔を糧に・・・。

## P1 Ceiling Installation

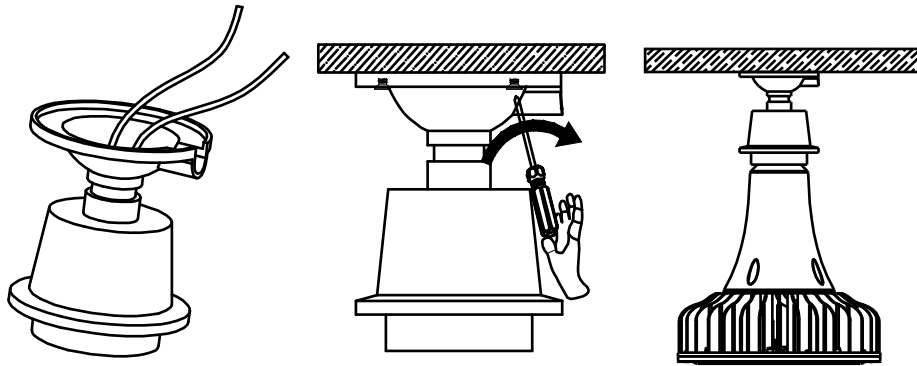

## P2 Hanging Installation

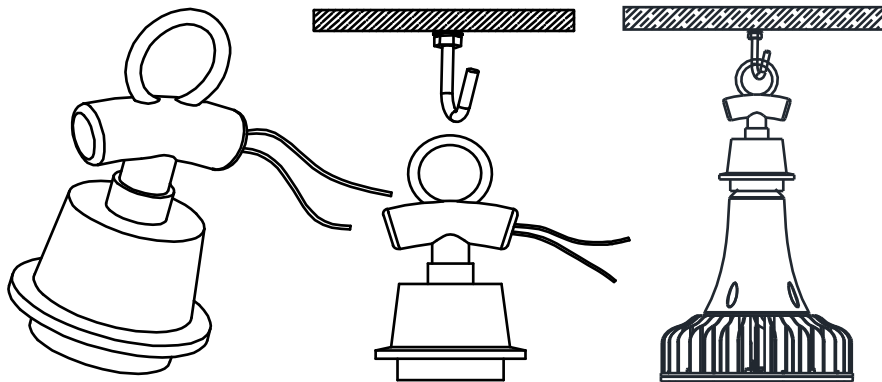

# LED HIGHBAY LIGHT

60W / 80W / 100W / 120W

170  
lm/W

## HBL-02-G7

Led Brand: SMD 5050



# Application



Warehouses



Workshops



Gymnasium



Supermarket



Shopping center



Shop



Showrooms



Steel Smelting Plants



Manufacturing Plants



Farms

# Quality System

Examination from strict QC technicians, engineers and customer service staff to ensure good quality.

## Quality Control Flowing Chart

